

XSERIES RV

XHUNTER

NEW X-SERIES HAS ARRIVED

19FT HARD ROOF TOY HAULER

BUILT FOR THE WILD - ENGINEERED FOR ADVENTURE

Unstoppable Off-Road Performance - Built for rugged adventures, the Hunter features a hot-dip galvanized steel chassis and independent adjustable suspension, conquering tough terrain with ease. Its aluminum composite body with XPS insulation offers durability and comfort in any environment. Equipped with gun storage, stone guard protection, and a slide-out kitchen, it's made for serious off-grid explorers.

Ultimate Off-Grid Comfort - Stay off-grid longer with a 300Ah lithium battery, 400W solar panels, and dual 95L fresh water tanks. Enjoy premium comforts like a beer fridge with built-in taps, a leather sofa, a movable dining table, and an innerspring mattress. The Hunter is your ultimate adventure base.



XSERIESRV.COM.AU

FOLLOW US



Q X SERIES RV AUSTRALIA



CAPACITY:
5 ADULTS



CHASSIS

ATM 3500kg*	●
Drawbar Tube Size 150mm x 50mm x 4mm Hot Dip Galvanised	●
16" Mud Terrain Tyres With 1 Spare Included	●
Alloy Rims	●
Heavy Duty Removable Jockey Wheel	●
Do35 Hitch with Receiver Coupling	●
12" Electric Brakes & Manual Handbrake	●

SUSPENSION

Off Road Independent Suspension System	●
Heavy Duty Coil Springs & Shock Absorbers	●

STORAGE

1 x Large Front Toolbox	●
Dedicated Fridge Slides with Power Supply	●
19+ Interior Storage Cupboards & Drawers	●
4 x External Storage Hatches & Drawers	●
2 x 9kg Gas Bottle Holders	●
2 x 20L Jerry Can Holders	●

KITCHEN & BATHROOM

Exterior Thetford 3 Burner Cooktops with Lighting & Gas Plumbing Connections	●
2 x 95L Fresh Water Tanks	●
1 x 90L Grey Water Tank	●
700w Microwave	●
286L and 85L Fridge	●
Thetford Toilet	●
Installed On Board Hot Water Unit	●
External Shower Outlet	●
Interior Ensuite Shower with Movable Rose Head, Roof Ventilation, LED Lighting & Full Size Mirror on Entry Door	●

SAFETY

Fire Extinguisher Included	●
ADR Approved Safety Chains & Coupling	●
Dual Internal Smoke and Carbon Monoxide Alarms	●
Reversing Camera Included	●

EXTERIOR GENERAL

Aluminium Composite Body	●
Black Raptorcoat Lower Body Wrap	●
Entry Door with Separate Screen Door	●
Electric Sunshade Awning with LED Lighting	●
Electric Operating Rear Loading Ramp/ Sundeck with Safety Railing, Roof with Lighting & 9 x Tie Down Points	●
Picnic Table with LED Lights	●
External Single Cold Brass Faucet	●
Stone Guard	●

INTERIOR GENERAL

Multimedia Touch Screen Stereo System & 24" Smart TV	●
Dometic Dual System Heating & Cooling Air Conditioner & Diesel Heater	●
Internal & External Changeable LED Lighting Throughout	●
Queen Size Main Bed	●
3 x Fold Away Single Beds	●
Dual Interior & Exterior Speakers	●
Windows with Block Out & Fly Screen Panels	●
Wood Printed Vinyl Flooring	●
Black Cabinetry Finishings with Soft Closing Drawers	●
Built In Sky Light Hatch with LED Lighting	●
Gun Storage	●
Magazine Pocket with Logo	●
Beer Taps Cooler / Fridge	●
Black Leather Sofa	●
Movable Table	●

POWER

REDARC Battery Management System with Solar Reg, Charging, & Bluetooth Controls	●
Anderson Plug Car Connections	●
300ah Lithium Batteries	●
400w Roof Mounted Solar Panels	●
3000 WATT - 12v / 240v Inverter System	●
240V Connection with Multiple GPO Points	●
Multiple 12V Sockets with Dedicated Fridge Sockets	●

CAMPING ACCESSORIES

62L Dual Zone Fridge Freezer	○
2KVA Generator	○

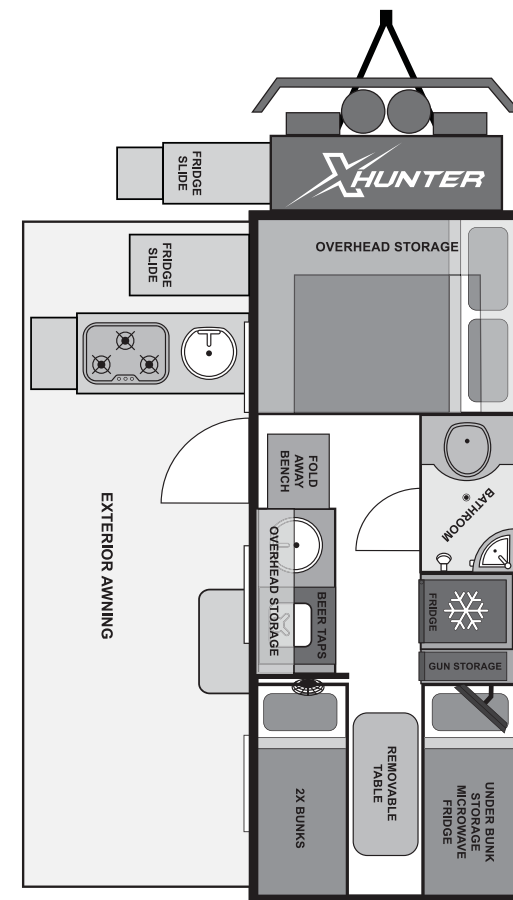

SIZE CLOSED - INCLUDES A/C
Length 8.1m - Width 2.4m - Height 3.1m

* Data accurate at time of print, please visit website product listing for more unit specifications & most current information.
 ** Weights are indicative and subject to change. The build specification will change the weight. Actual weights will be displayed on compliance plates at time of build.
 Pods only have diesel heater but other models have both Dometic aircon/diesel heaters

2075-150225



ATM
APPROX.
3500KG



CHARGER SYSTEM
REDARC POWER
SYSTEM & INVERTER



BATTERY
300AH
LITHIUM



POWER
240V CONNECTION
INCLUDED



WATER TANKS
2 x 95L CLEAN
1 x 90L GREY



HEATING & COOLING
DOMETIC DUAL SYSTEM
INC. & DIESEL HEATER



CAPACITY
5 ADULTS



GAS & JERRY HOLDERS
2 x 9KG GAS
2 x 20L JERRY